



Quick guide for foot control S-NW

CAN-Dongle



Pairing

The foot control S-NW and the CAN dongle are paired by default.

Connecting CAN dongle

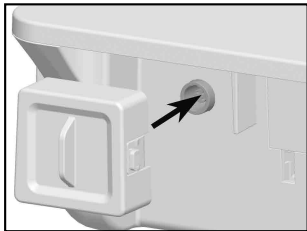

❶ Plug in the CAN dongle.



Pay attention to the positioning!

Removing CAN dongle

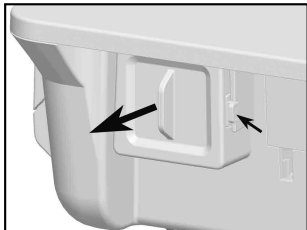

❷ Press the side lock and remove the CAN dongle.

CAN dongle activated



Icon am Display sichtbar

- > CAN dongle inserted
- > Control unit switched on
- > Foot control actuated

SPI-Dongle



Pairing

The foot control S-NW and the CAN dongle are paired by default.

Connecting and disconnecting the SPI dongle

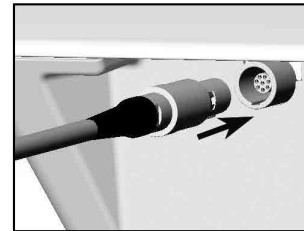

Pay attention to the positioning!

❶ Plug in the SPI dongle or disconnect the SPI dongle from the control unit.

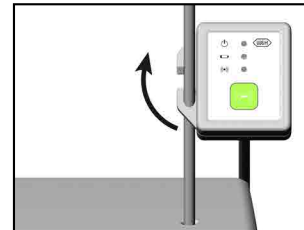

❷ Attach the SPI dongle to the irrigant support or remove the SPI dongle from the irrigant support.



GREEN – SPI dongle activated

LED on if the SPI dongle is connected and the control unit is switched on.

ORANGE – battery

LED flashes if the batteries on the foot control need to be replaced.

BLUE – pairing





Quick guide for foot control S-NW

Changing the batteries

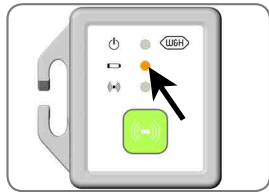

SI-923, SI-915, SA-310, SA-320



SI-1023, SI-1015

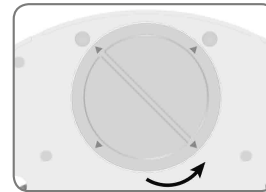

Open the battery compartment

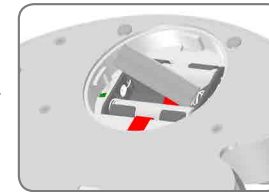

Insert the batteries

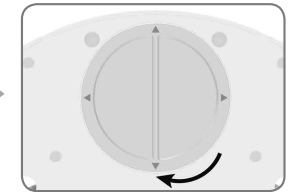

Lock the battery compartment

CAN Dongle Pairing

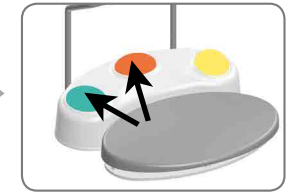
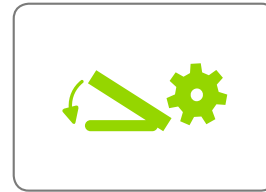
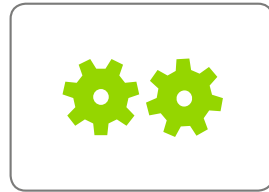
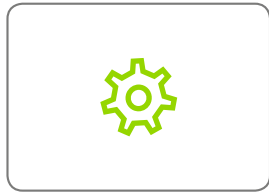

4 seconds

SPI Dongle Pairing

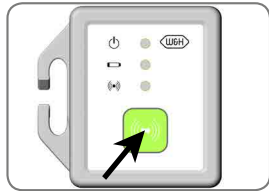

At least 3 seconds

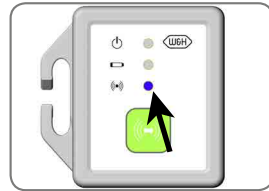

Blue LED flashes

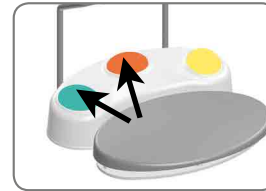

At least 3 seconds

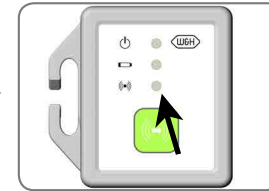

Blue LED off

Switching between control units

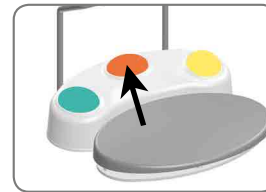

At least 3 seconds



Disable pairing

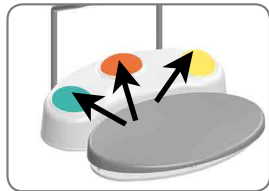

At least 3 seconds